

REV DATE BY

NOTE:
UNLESS PRINTED FULL SIZE, THESE DRAWINGS WILL NOT BE TO SCALE.

THESE DRAWINGS, SPECIFICATIONS AND DESIGNS ARE THE PROPERTY OF THE MONMOUTH COUNTY PARK SYSTEM (MPCPS). NO PART THEREOF SHALL BE COPIED OR USED WITH ANY OTHER WORK OTHER THAN THE SPECIFIC PROJECT FOR WHICH THEY HAVE BEEN DEVELOPED WITHOUT THE WRITTEN CONSENT OF MPCPS. ANYONE WHO FAILS TO FOLLOW THESE PLANS, SPECIFICATIONS AND DESIGN INTENT TO OBTAIN AND/OR FOLLOW THE DESIGN PROFESSIONAL'S GUIDANCE WITH RESPECT TO ANY ERRORS, OMISSIONS, INCONSISTENCIES, AMBIGUITIES OR CONFLICTS WHICH ARE ALLEGED.

MONMOUTH COUNTY PARK SYSTEM
BOARD OF PARK AND RECREATION COMMISSIONERS
805 NEWMAN SPRINGS ROAD
LINCROFT, NEW JERSEY 07738-1865
PHONE (732) 842-4000 FAX (732) 842-3640



CART PATH REPAIRS
HOWELL PARK GOLF COURSE

DATE 5/2016 SCALE 1"=400' PROJECT # DRAWN SCJ CHECKED SCJ

SHEET NO.
1 OF 5





REPAIR LEGEND

- ① = CUT AND PATCH
- △ = OVERLAY
- = WIDEN

HOLES 1,2,3 8 and 9

EXACT LOCATION OF REPAIRS SHALL BE MARKED OUT WITH CONTRACTOR AND MCPS ENGINEER PRIOR TO STARTING WORK.



SHEET 1	HOLE	LOCATION	CUT/PATCH	OVERLAY	WIDEN
1	PARKING	LOT	30		POT HOLE
2	CLUB	HOUSE	50		
3	CLUB	HOUSE	100		
4	CLUB	HOUSE			650
5	1	TEE		250	
6	1	TEE			75
7	1	FAIRWAY		300	
8	1	GREEN		225	
9	1	GREEN		1,450	
10	2	TEE			110
11	2	TEE		1,000	
12	2	FAIRWAY		450	
13	2	FAIRWAY		200	
14	3	TEE		1,000	
15	3	TEE		900	
16	3	FAIRWAY	30		
17	8	FAIRWAY	120		
18	8	FAIRWAY	125*		
19	8	FAIRWAY	30		AT BRIDGE
20	8	GREEN		900	
21	8	GREEN		1,200	
22	9	TEE	160		
23	9	TEE		250	
24	9	FAIRWAY	100		
25	9	GREEN		350	

REV DATE BY

NOTE: UNLESS PRINTED FULL SIZE, THESE DRAWINGS WILL NOT BE TO SCALE.

THESE DRAWINGS, SPECIFICATIONS AND DESIGNS ARE THE PROPERTY OF THE MONMOUTH COUNTY PARK SYSTEM (MCPS). NO PART THEREOF SHALL BE COPIED OR USED WITH ANY OTHER PROJECT OR FOR ANY OTHER PURPOSE WITHOUT THE WRITTEN CONSENT OF MCPS. MCPS MAKES NO WARRANTY AND ALL RESPONSIBILITY AND LIABILITY FOR PROBLEMS WHICH MAY BE CAUSED BY FAILURE TO FOLLOW THESE PLANS, SPECIFICATIONS AND DESIGN INTENT IS SOLELY THE RESPONSIBILITY OF THE USER. MCPS SHALL NOT BE RESPONSIBLE FOR ANY DAMAGES, LOSSES, INCONVENIENCES, ABANDONMENTS, OR CONFLICTS WHICH ARE ALLEGED.

MONMOUTH COUNTY PARK SYSTEM
BOARD OF PARK AND RECREATION COMMISSIONERS
800 NEWMAN SPRINGS ROAD
LINCOLN, NEW JERSEY 07738-1985
PHONE (732) 942-4000 FAX (732) 842-3640



CAR PATH REPAIRS
HOWELL PARK GOLF COURSE

DATE 1/24 SCALE 1"=20' PROJECT # DRAWN SCJ CHECKED SCJ

SHEET NO. 2 OF 5

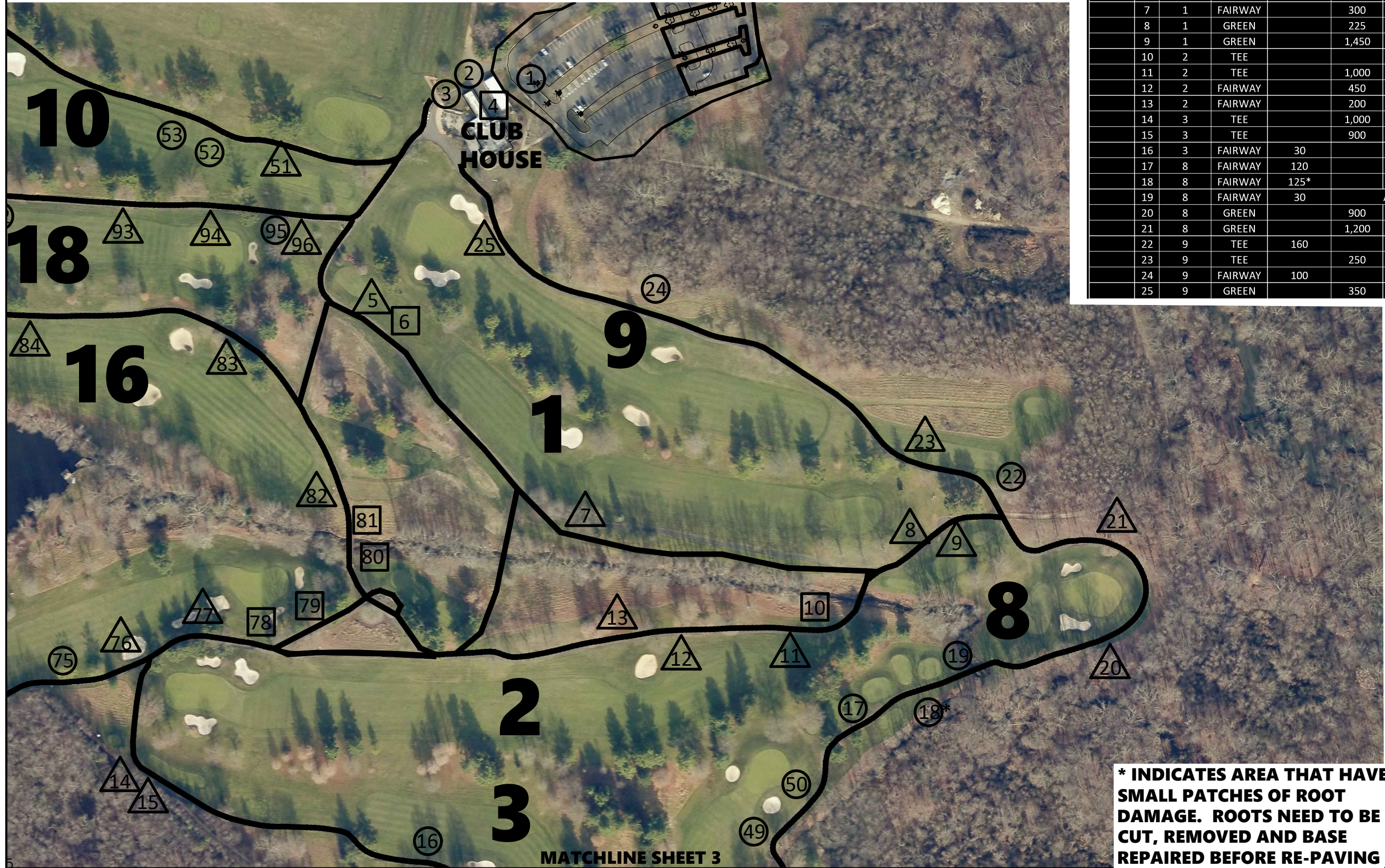

*** INDICATES AREA THAT HAVE SMALL PATCHES OF ROOT DAMAGE. ROOTS NEED TO BE CUT, REMOVED AND BASE REPAIRED BEFORE RE-PAVING**

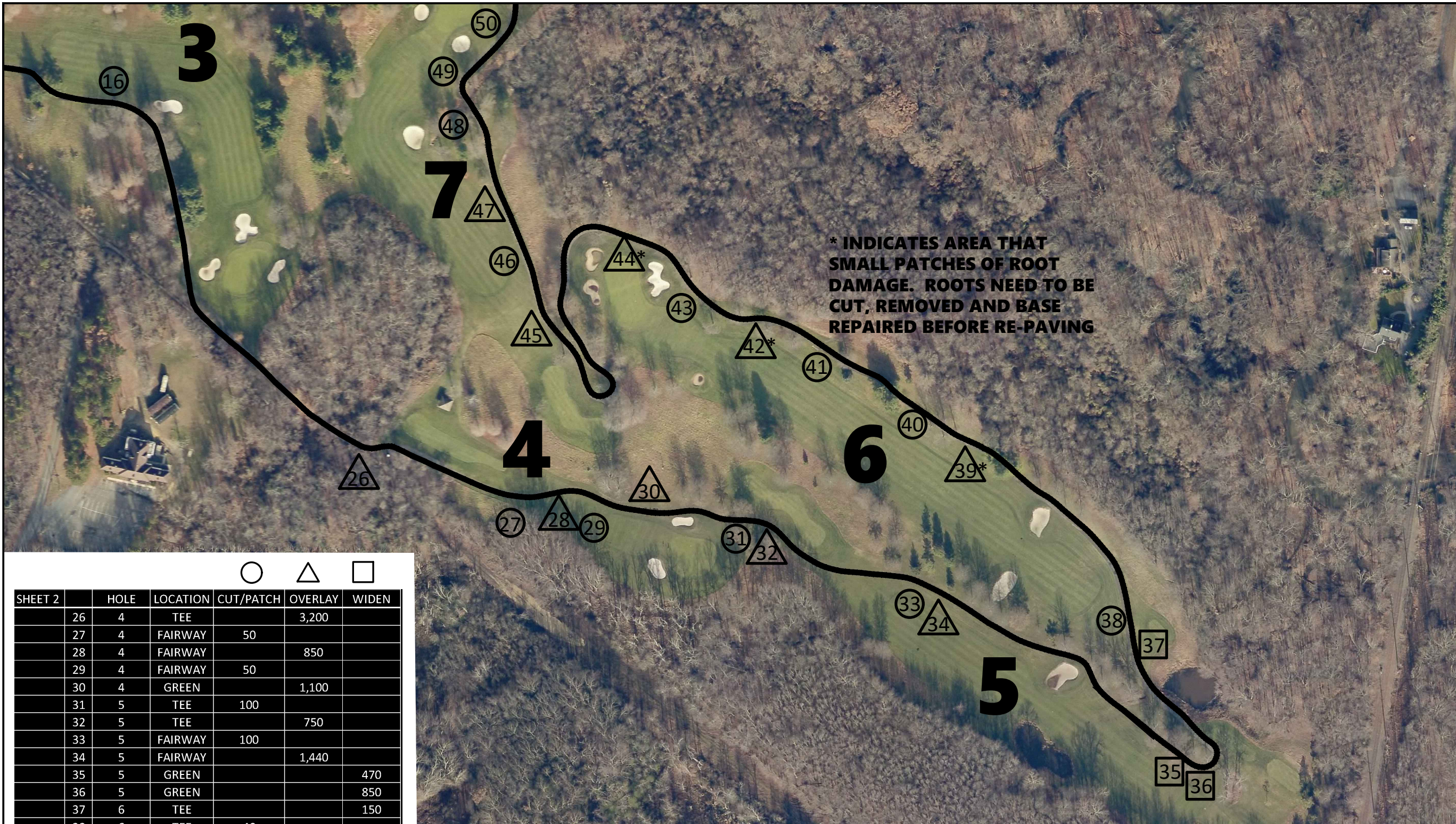

*** INDICATES AREA THAT SMALL PATCHES OF ROOT DAMAGE. ROOTS NEED TO BE CUT, REMOVED AND BASE REPAIRED BEFORE RE-PAVING**

SHEET 2	HOLE	LOCATION	CUT/PATCH	OVERLAY	WIDEN
26	4	TEE		3,200	
27	4	FAIRWAY	50	850	
28	4	FAIRWAY	50		
29	4	FAIRWAY	50		
30	4	GREEN		1,100	
31	5	TEE	100		
32	5	TEE		750	
33	5	FAIRWAY	100		
34	5	FAIRWAY		1,440	
35	5	GREEN			470
36	5	GREEN			850
37	6	TEE			150
38	6	TEE	40		
39	6	FAIRWAY		600 *	
40	6	FAIRWAY	75		
41	6	FAIRWAY	150		
42	6	FAIRWAY		200 *	
43	6	GREEN	125		
44	6	GREEN		500 *	
45	7	TEE		525	
46	7	FAIRWAY	100		
47	7	FAIRWAY		180	
48	7	FAIRWAY	65		AT BRIDGE
49	7	FAIRWAY	50		AT BRIDGE
50	7	GREEN	65		

EXACT LOCATION OF REPAIRS SHALL BE MARKED OUT WITH CONTRACTOR AND MCPS ENGINEER PRIOR TO STARTING WORK.

- REPAIR LEGEND**
- ① = CUT AND PATCH
 - △ = OVERLAY
 - = WIDEN
- HOLES 4,5,6 and 7**



REV _____ DATE _____ BY _____

NOTE:
UNLESS PRINTED FULL SIZE, THESE DRAWINGS WILL NOT BE TO SCALE.

THESE DRAWINGS, SPECIFICATIONS AND DESIGN ARE THE PROPERTY OF THE MONMOUTH COUNTY PARK SYSTEM (MCPS). NO PART THEREOF SHALL BE COPIED OR USED WITH ANY OTHER WORK OTHER THAN THE SPECIFIC PROJECT FOR WHICH THEY HAVE BEEN DEVELOPED. WITHOUT THE WRITTEN CONSENT OF MCPS, NO PART SHALL BE AND ALL RESPONSIBILITY AND LIABILITY FOR PROBLEMS WHICH ARISE FROM FAILURE TO FOLLOW THESE PLANS, SPECIFICATIONS AND DESIGN INTENT THEY CONSENT, OR FOR PROBLEMS WHICH ARISE FROM OTHERS' FAILURE TO OBTAIN AND/OR FOLLOW THE DESIGN PROFESSIONAL'S GUIDANCE WITH RESPECT TO ANY EXISTING CONDITIONS, CIRCUMSTANCES, ABNORMALITIES OR CONFLICTS WHICH ARE ALLEGED.

MONMOUTH COUNTY PARK SYSTEM
BOARD OF PARK AND RECREATION COMMISSIONERS
805 NEWMAN SPRINGS ROAD
LINCOLN, NEW JERSEY 07738-1965
PHONE (732) 842-4000 FAX (732) 842-3640



CART PATH REPAIRS
HOWELL PARK GOLF COURSE

DATE: 1/24 SCALE: 1"=20' PROJECT # _____ DRAWN: SCJ CHECKED: SCJ

SHEET NO. _____
3 OF 5

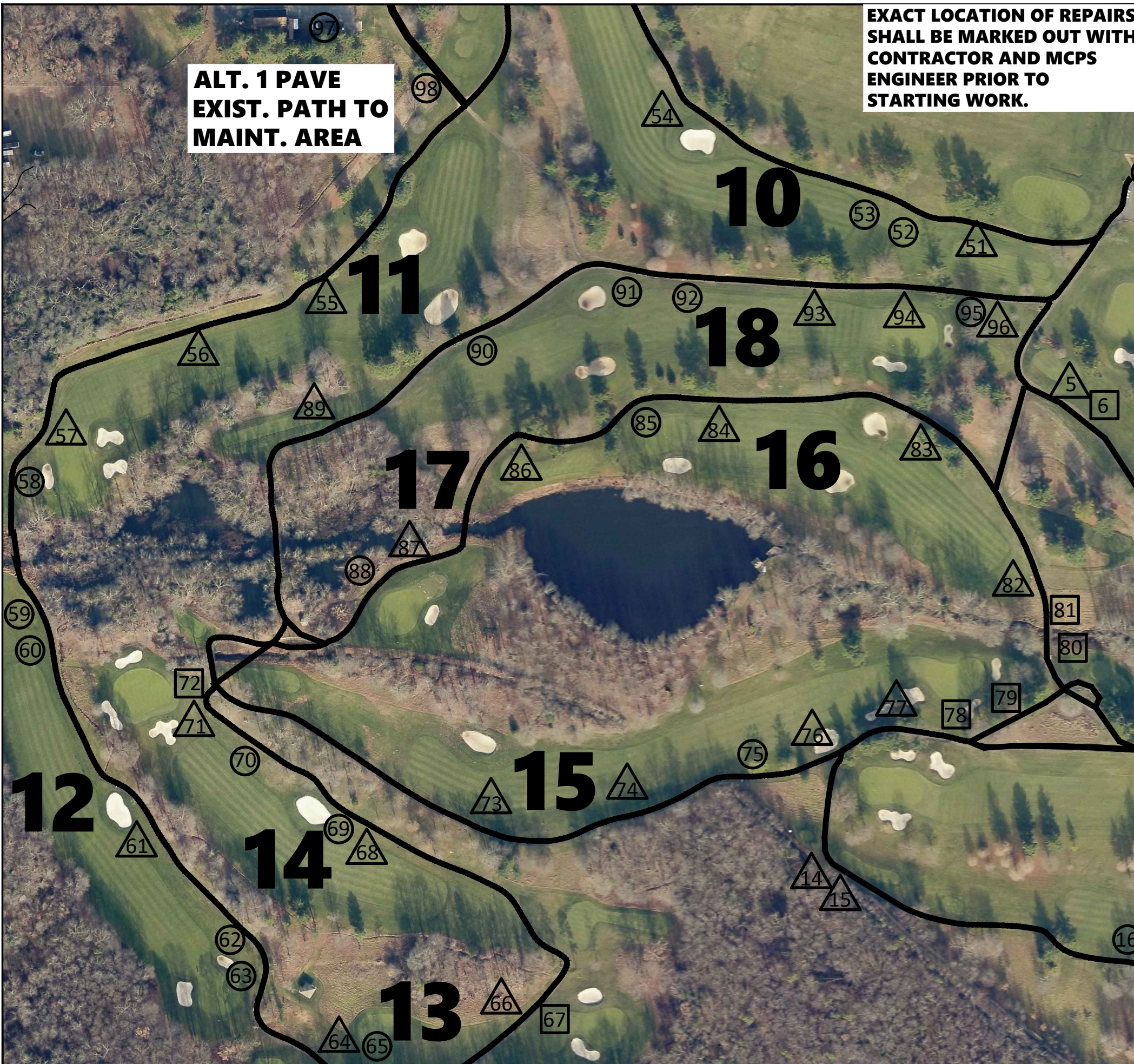

**ALT. 1 PAVE
EXIST. PATH TO
MAINT. AREA**

**EXACT LOCATION OF REPAIRS
SHALL BE MARKED OUT WITH
CONTRACTOR AND MCPS
ENGINEER PRIOR TO
STARTING WORK.**

	HOLE	LOCATION	CUT/PATCH	OVERLAY	WIDEN
51	10	TEE		550	
52	10	TEE	25		
53	10	TEE	40		
54	10	FAIRWAY		800	
55	11	FAIRWAY		600	
56	11	FAIRWAY		700	
57	11	GREEN		600	
58	11	GREEN	100		
59	12	TEE	100		
60	12	TEE	100		
61	12	FAIRWAY		1,100	
62	12	GREEN	50		
63	12	GREEN	30		
64	13	TEE		1,500	
65	13	TEE	50		
66	13	GREEN		3,800	
67	13	GREEN			60
68	14	FAIRWAY		500	
69	14	FAIRWAY	125		
70	14	FAIRWAY	50		
71	14	GREEN		2,400	
72	14	GREEN			60
73	15	FAIRWAY		200	
74	15	FAIRWAY		1,200	
75	15	FAIRWAY	50		
76	15	FAIRWAY		3,250	
77	15	GREEN		3,350	
78	15	GREEN			125
79	15	GREEN			100
80	16	TEE			60
81	16	TEE			100
82	16	TEE		1,350	
83	16	FAIRWAY		300	
84	16	FAIRWAY		750	
85	16	GREEN	50		
86	17	TEE		1,460	
87	17	GREEN		2,900	
88	17	GREEN	75		
89	18	TEE		1,370	
90	18	FAIRWAY	25		
91	18	FAIRWAY	50		
92	18	FAIRWAY	75		
93	18	FAIRWAY		3,500	
94	18	GREEN		1,600	
95	18	GREEN	150		
96	18	GREEN		1,150	
97	MAINT.	AREA	350		
	TOTAL	SQ FEET	2,905	51,450	2,160
	NUMBER	OF AREAS	39	46	12
98	MAINT.	AREA	3,500	ALT 1	

REPAIR LEGEND

① = WIDEN

△ = CUT AND PATCH

□ = OVERLAY

↑ = WIDEN

HOLES 10 THROUGH 18

REV _____ DATE _____ BY _____

NOTE: UNLESS PRINTED FULL SIZE, THESE DRAWINGS WILL NOT BE TO SCALE.

THESE DRAWINGS, SPECIFICATIONS AND DESIGN ARE THE PROPERTY OF THE MONMOUTH COUNTY PARK SYSTEM (MCPS). NO PART THEREOF SHALL BE COPIED OR REPRODUCED IN ANY MANNER WITHOUT THE WRITTEN CONSENT OF MCPS. MCPS MAKES NO WARRANTY, REPRESENTATION OR GUARANTEE, AND ALL RESPONSIBILITY AND LIABILITY FOR PROBLEMS WHICH MAY ARISE FROM FAILURE TO FOLLOW THESE PLANS, SPECIFICATIONS AND DESIGN INTENT SHALL BE THE RESPONSIBILITY OF THE USER. THE DESIGN PROFESSIONAL'S LIABILITY IS LIMITED TO THE DESIGN PROFESSIONAL'S OBLIGATION TO DESIGN AND/OR FOLLOW THE DESIGN PROFESSIONAL'S GUIDANCE WITH RESPECT TO ANY DESIGN, OMISSIONS, INCONSISTENCIES, AMBIGUITIES OR CONFLICTS WHICH ARE ALLEGED.

MONMOUTH COUNTY PARK SYSTEM
BOARD OF PARK AND RECREATION COMMISSIONERS
805 NEWMAN SPRINGS ROAD
LINCOLN, NEW JERSEY 07738-1965
PHONE (732) 842-4000 FAX (732) 842-3640



CART PATH REPAIRS
HOWELL PARK GOLF COURSE

DATE: 1/24 SCALE: 1"=20' PROJECT # _____ DRAWN: SCJ CHECKED: _____

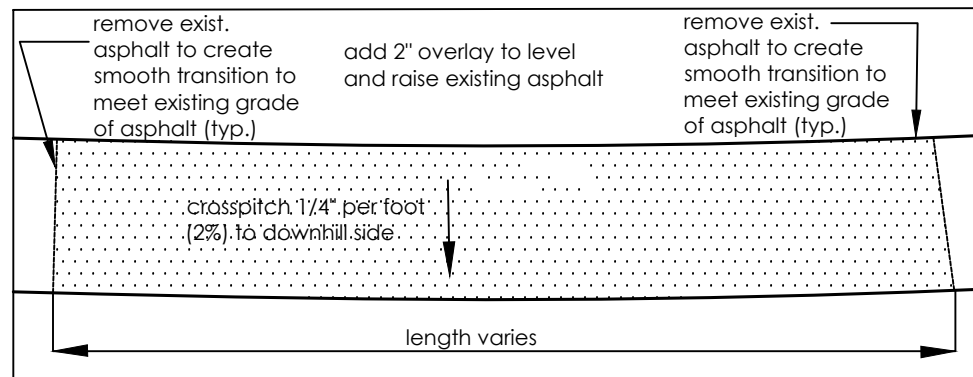

Detail: Typical Asphalt Overlay
not to scale

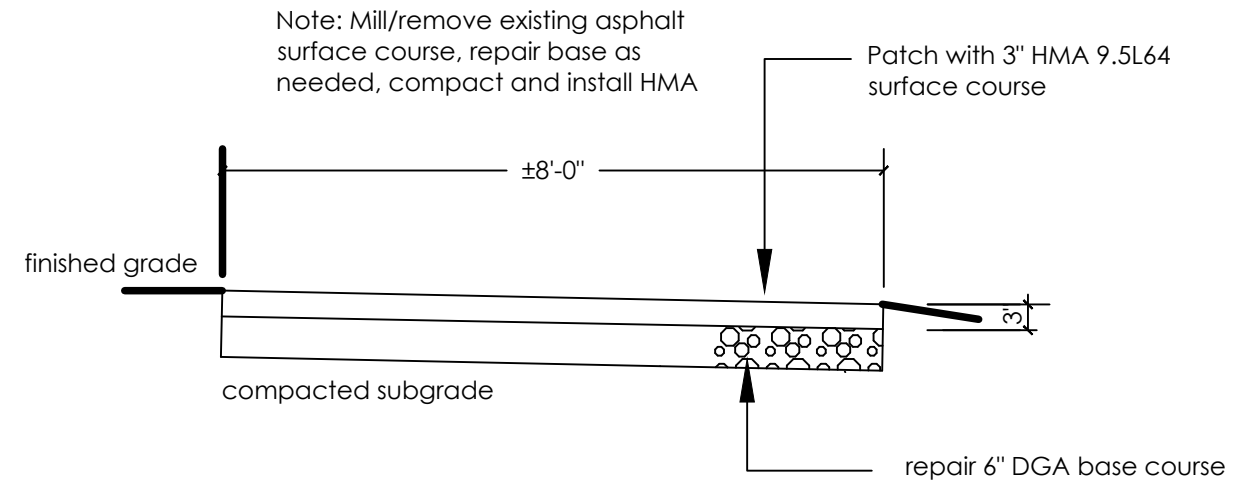

Detail: Patching of Cart Path
not to scale

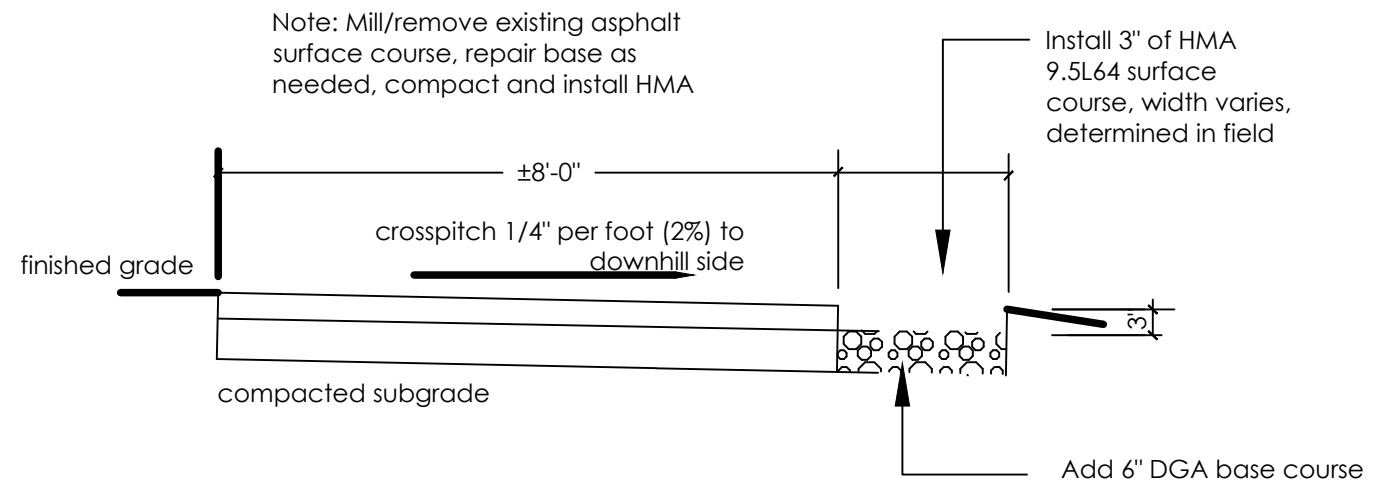

Detail: Widened area of Cart Path
not to scale

Notes

1. Call for utility mark out prior to construction - 1-800-272-1000 for public utilities. Coordinate with the Park System for mark out of park utilities.
2. All cart paths are approximately 8 feet wide unless noted otherwise.
3. The Contractor with the Owner will determine if any tree branches overhanging the cartpaths will determine any limbs that will conflict with construction vehicles. The Owner will prune and dispose of the branches.
4. All work must be performed from the cart paths. Equipment and vehicles are not permitted on adjacent grassed areas. Any areas disturbed from construction must be restored in accordance with the specifications. Restore ruts, Golf staff will re-seed damaged areas.
5. Access all work from the construction access points on the plan and perform work starting at the far end of the cartpaths, working back to construction access at maintenance area.
6. Locations of repairs noted on the plan are approximate. The Contractor and Owner shall mark the location of all repairs in the field.

CONSTRUCTION NOTES

- **Existing cart paths to be repaired** - saw cut and remove damaged area, compact base, add DGA as necessary and patch with HMA to match existing grade.
- **Overlay** - after repairing damaged areas repave area with HMA to increase elevation (see detail above for required additional depth) and cross pitch 2% to downhill side.
- **Cracks caused by tree root(s)** - Contractor shall cut roots along sides of cart paths - Contractor is responsible for the following: cut and remove asphalt around damaged areas, remove severed roots with in cart path, grub to a 9 inch depth and remove all additional roots within the area by cutting the root with sharp pruning shears or a pruning saw, fill voids in the base course with DGA and compact and patch with HMA to match existing grade.

REV	DATE	BY

NOTE: UNLESS PRINTED FULL SIZE, THESE DRAWINGS WILL NOT BE TO SCALE.

THESE DRAWINGS, SPECIFICATIONS AND DESIGNS ARE THE PROPERTY OF THE MONMOUTH COUNTY PARK SYSTEM (MPCPS). NO PART THEREOF SHALL BE COPIED OR USED WITH ANY OTHER WORK OTHER THAN THE SPECIFIC PROJECT FOR WHICH THEY HAVE BEEN DEVELOPED. WITHOUT THE WRITTEN CONSENT OF MPCPS, NO PART SHALL BE REPRODUCED, COPIED, OR FOR ANY AND ALL RESPONSIBILITY AND LIABILITY FOR PROBLEMS WHICH ARISE FROM FAILURE TO FOLLOW THESE PLANS, SPECIFICATIONS AND DESIGN INTENT THEY COMEY, OR FOR PROBLEMS WHICH ARISE FROM OTHER FAILURE TO OBEY AND/OR FOLLOW THE DESIGN PROFESSIONAL'S GUIDANCE WITH REGARD TO ANY ERRORS, OMISSIONS, INCONSISTENCIES, AMBIGUITIES OR CONFLICTS WHICH ARE ALLEGED.

MONMOUTH COUNTY PARK SYSTEM
BOARD OF PARK AND RECREATION COMMISSIONERS
805 NEWMAN SPRINGS ROAD
LINCOLN, NEW JERSEY 07738-1985
PHONE (732) 842-4000 FAX (732) 842-3640



CART PATH REPAIRS
HOWELL PARK GOLF COURSE

DATE 1/24 SCALE PROJECT # DRAWN SCJ CHECKED